

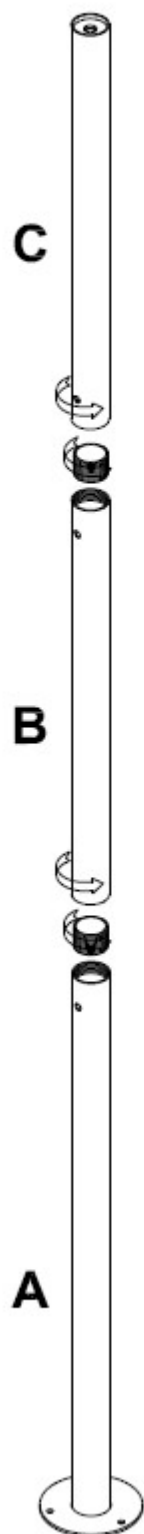

ASSEMBLAGE DU MÂT INTERNE

226 < HT < 321



HT > 321

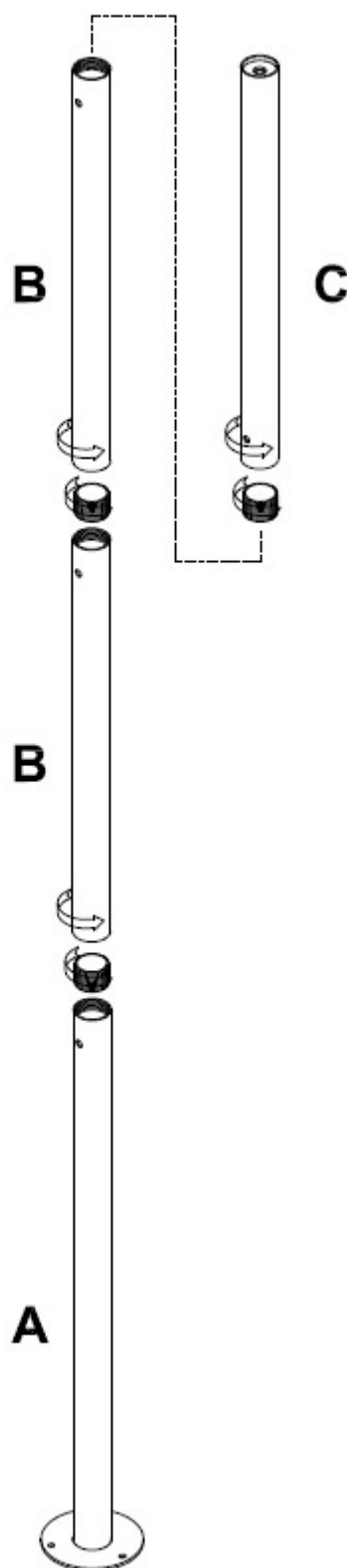

HT < 226



FORME ET DIMENSION DE L'ESCALIER

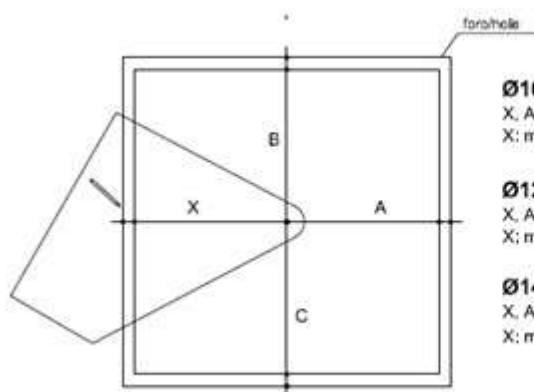
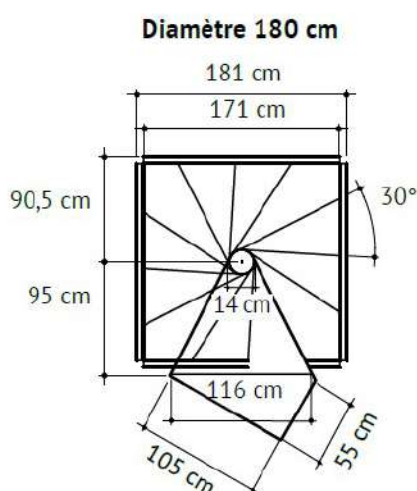
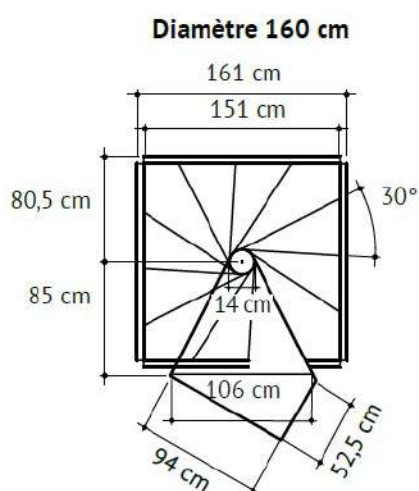
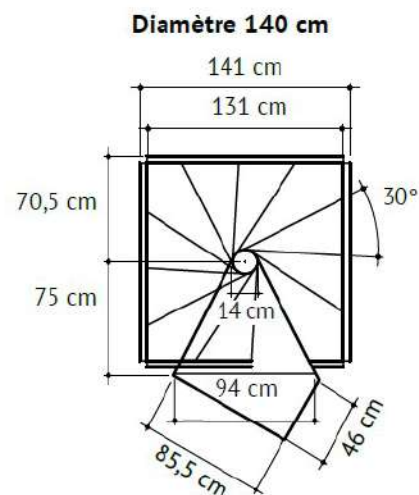
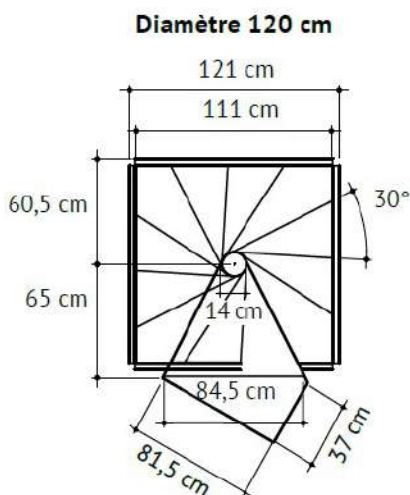
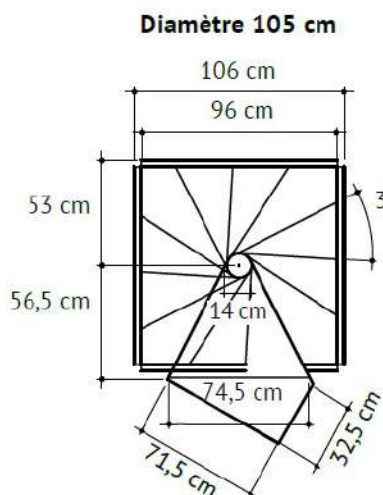

Ø105

X, A, B, C: min 55 cm
X: max 56,5 cm

Ø120

X, A, B, C: min 62,5 cm
X: max 65 cm

Ø140

X, A, B, C: min 72,5 cm
X: max 75 cm

Ø160

X, A, B, C: min 82,5 cm
X: max 85 cm

Ø180

X, A, B, C: min 92,5 cm
X: max 95 cm

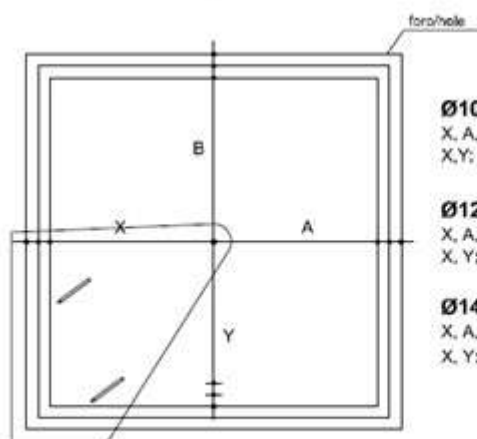

Ø105

X, A, B, C: min 55 cm
X, Y: max 62,5 cm

Ø120

X, A, B, C: min 62,5 cm
X, Y: max 72,5 cm

Ø140

X, A, B, C: min 72,5 cm
X, Y: max 82,5 cm

Ø160

X, A, B, C: min 82,5 cm
X, Y: max 92,5 cm

Ø180

X, A, B, C: min 92,5 cm
X, Y: max 100 cm

TRÉMIE CARRÉE

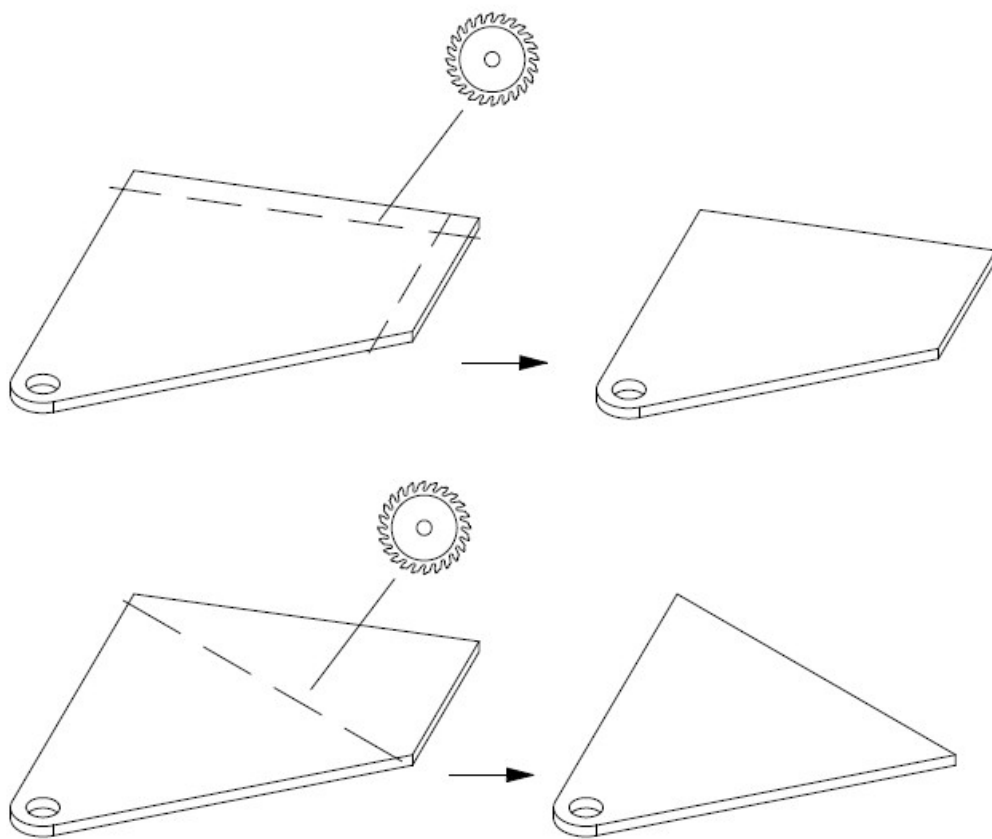
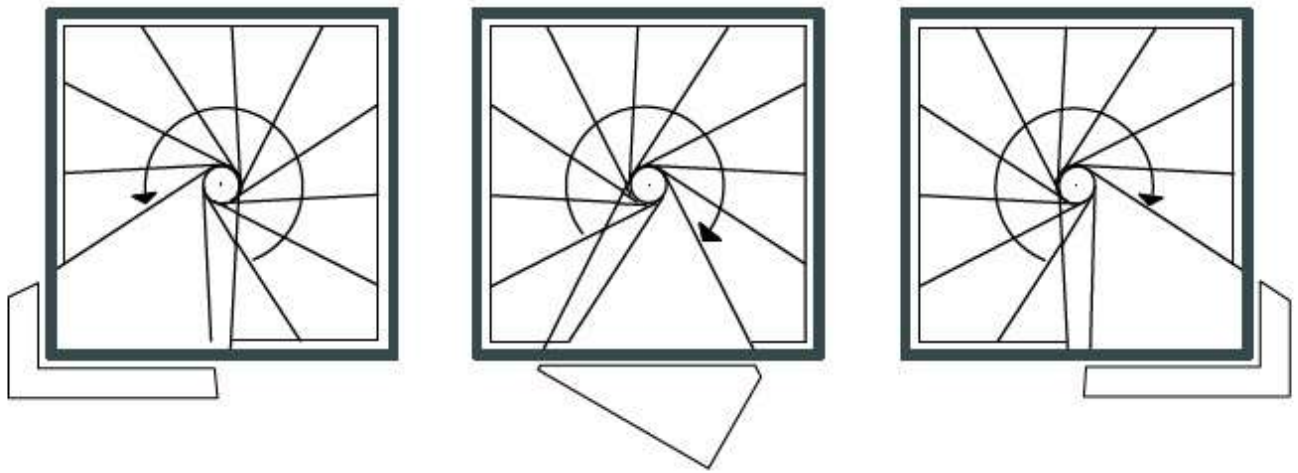



Atterrissage triangulaire

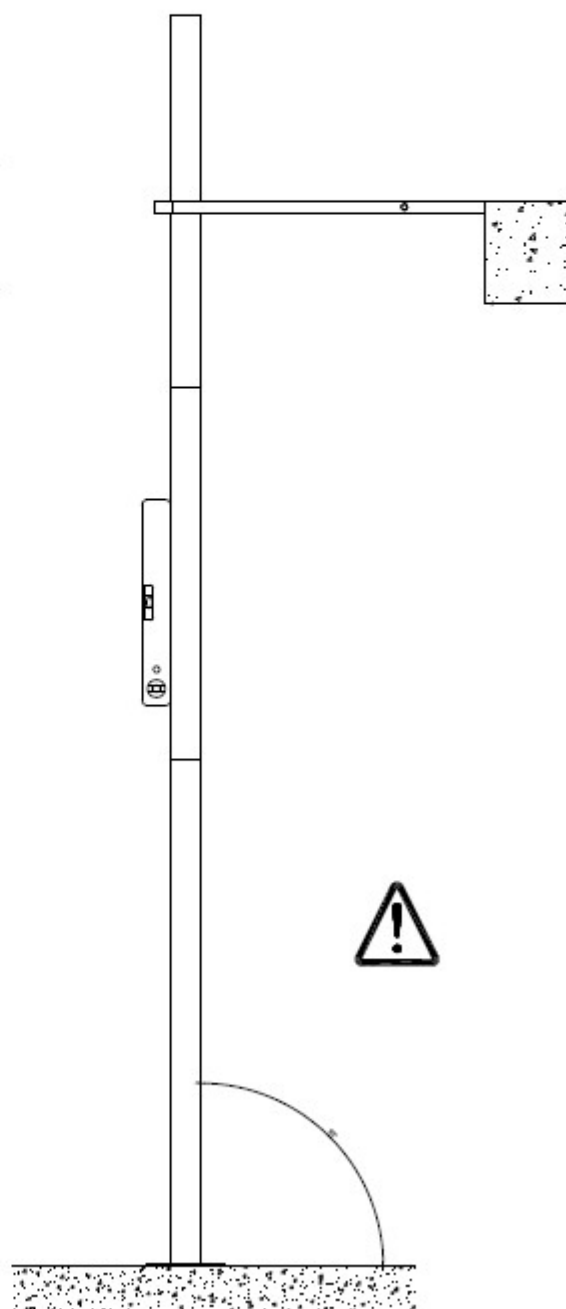
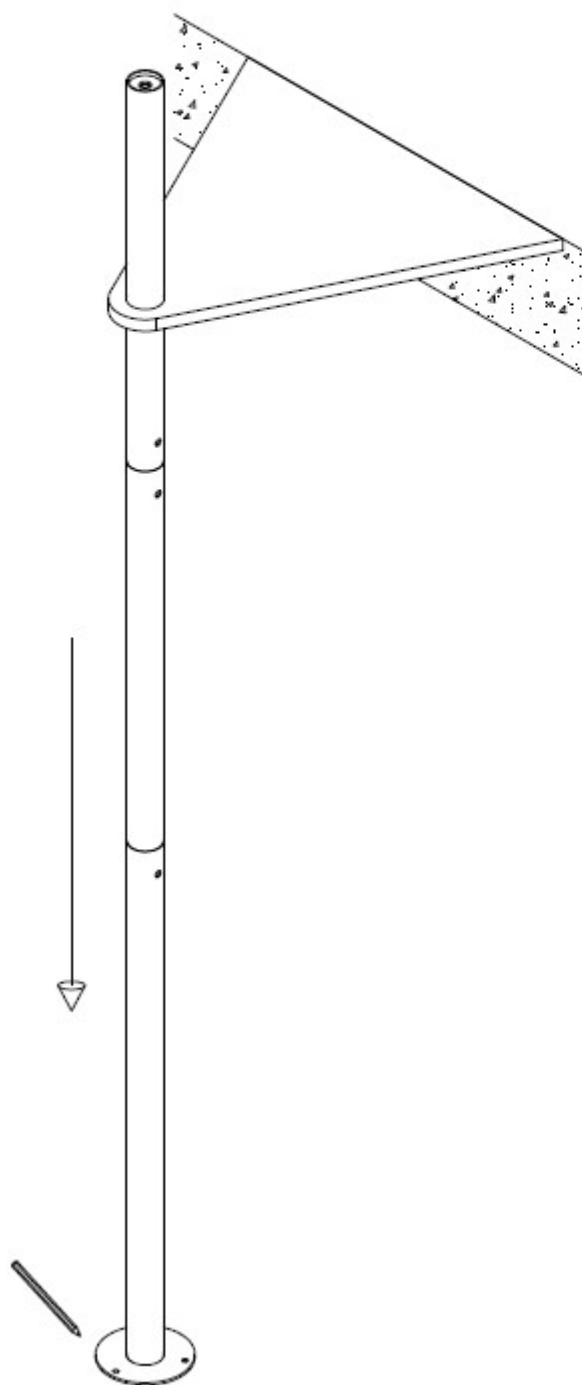
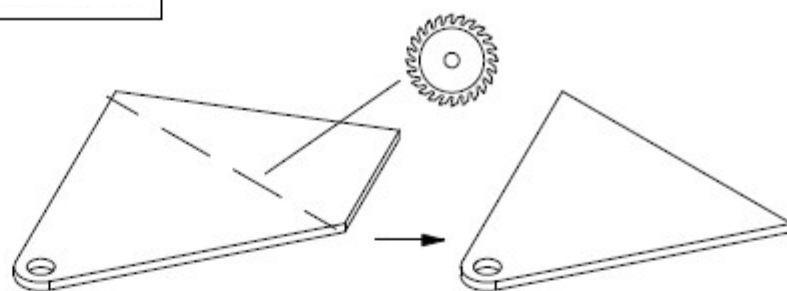

Fixation au sol

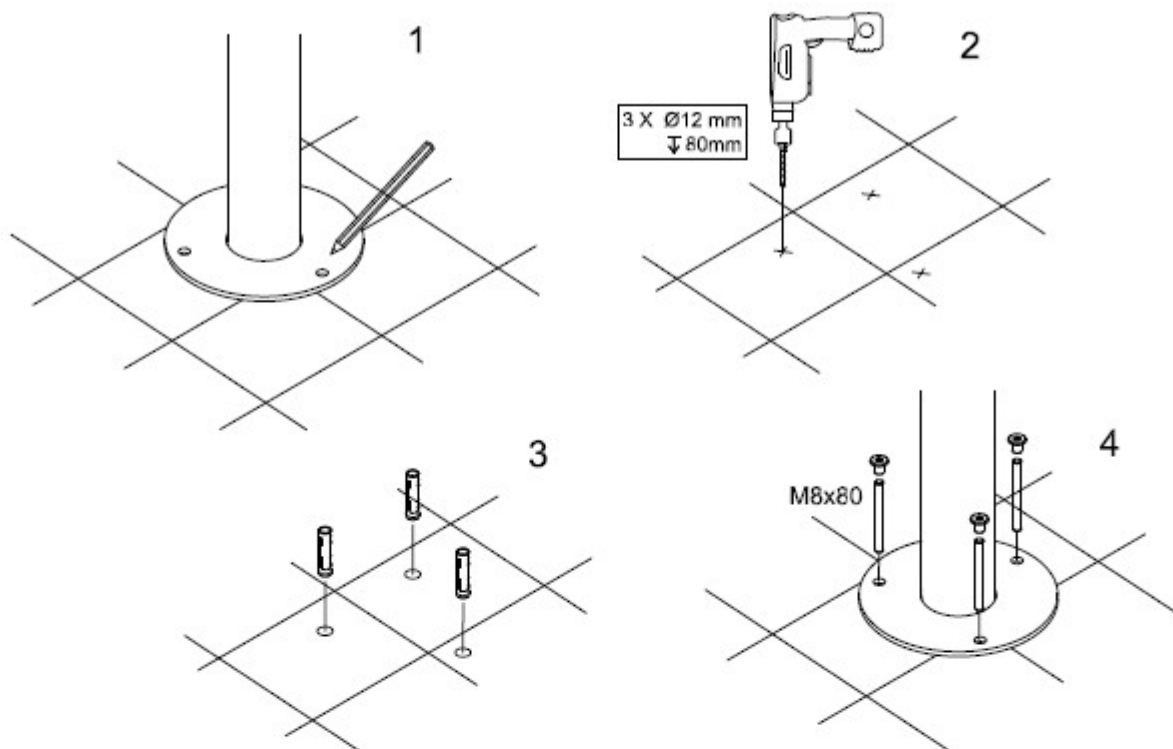

Visserie fournie, adaptée
uniquement pour le béton/la maçonnerie

Insertion du cache-plaque de départ

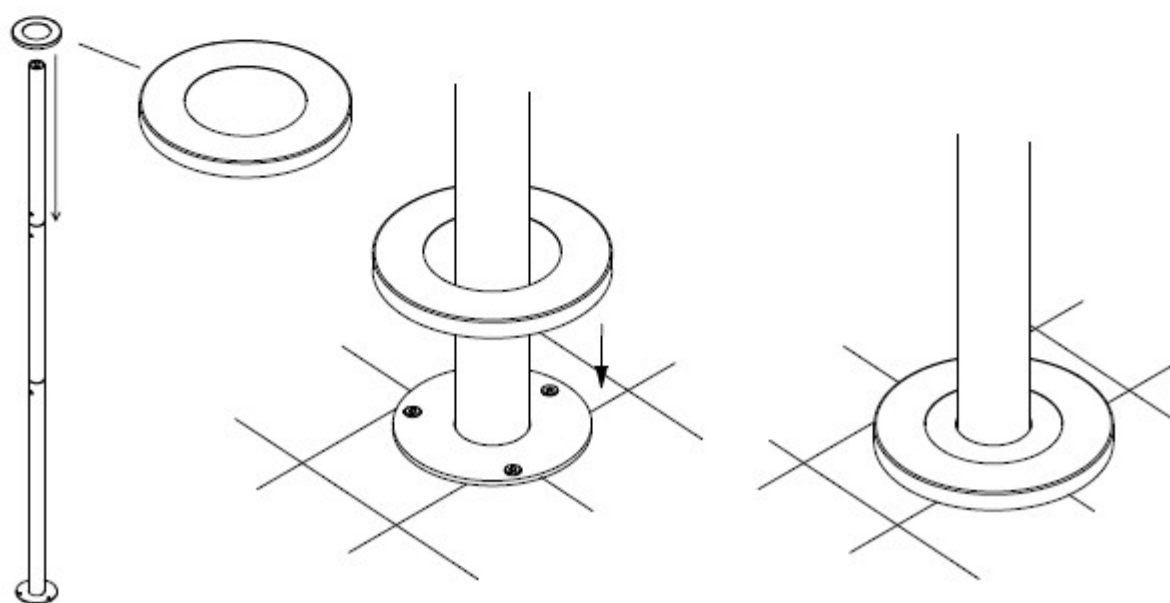

Poinçonnage de marches pour garde-corps

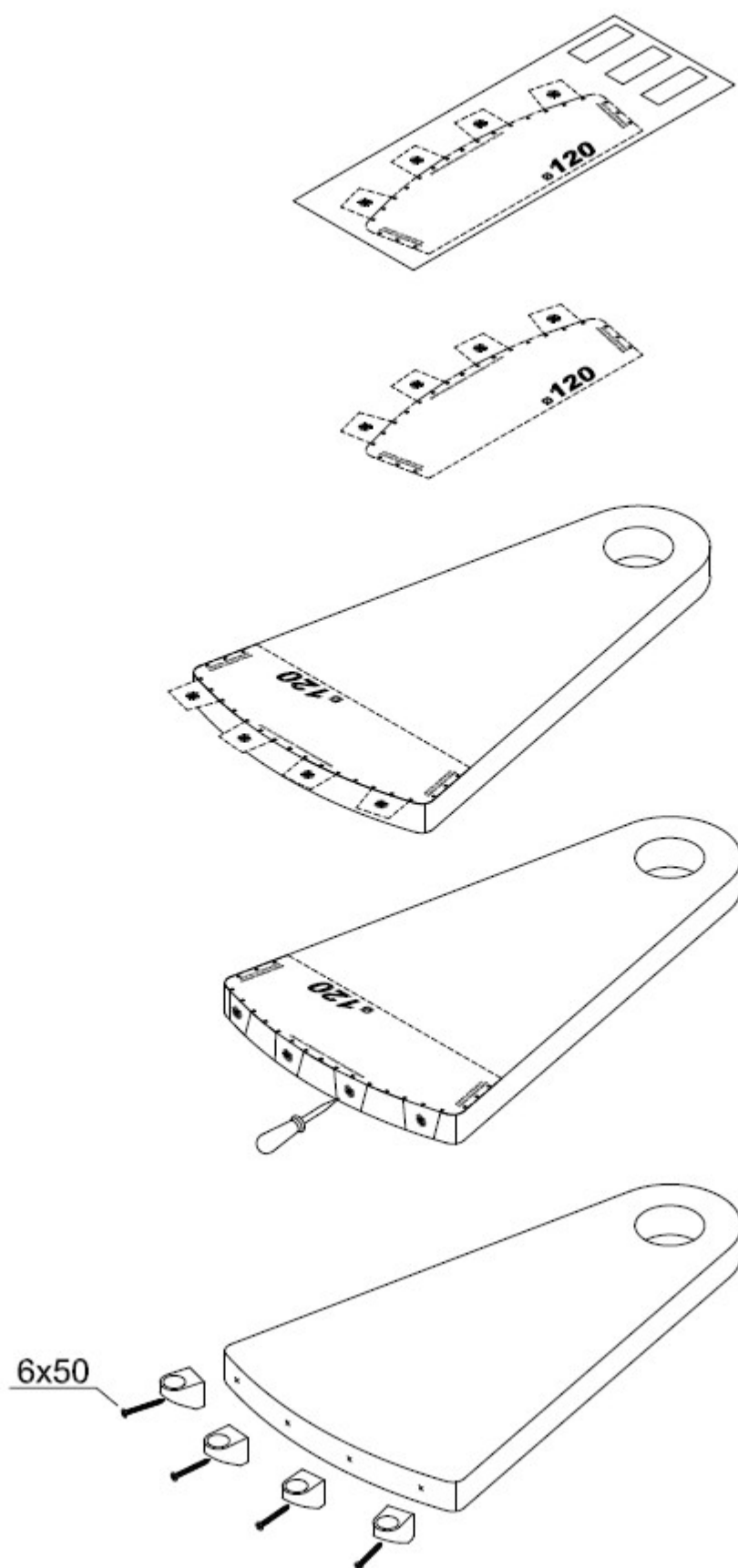

COMPOSITION DES CONTREMARCHES

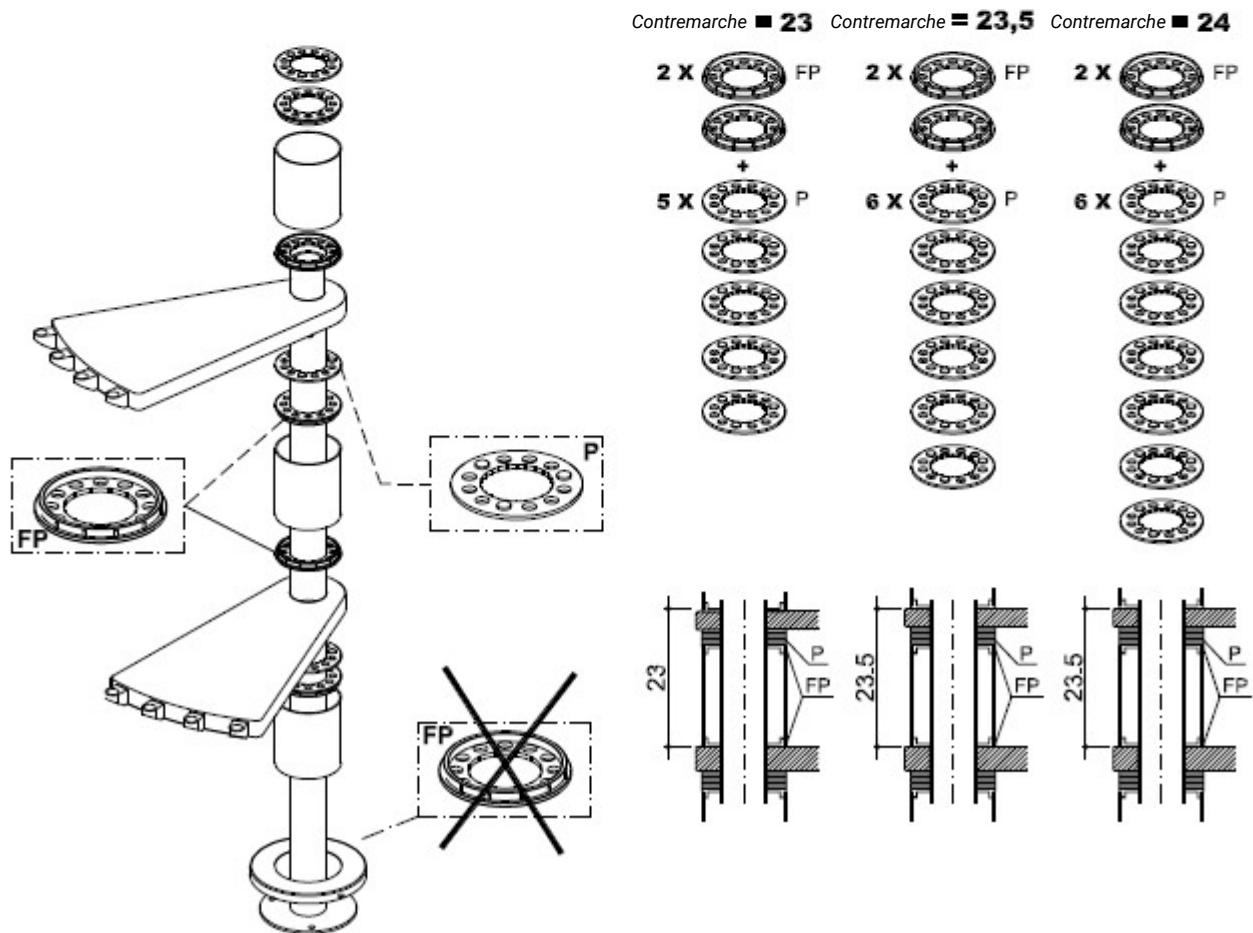
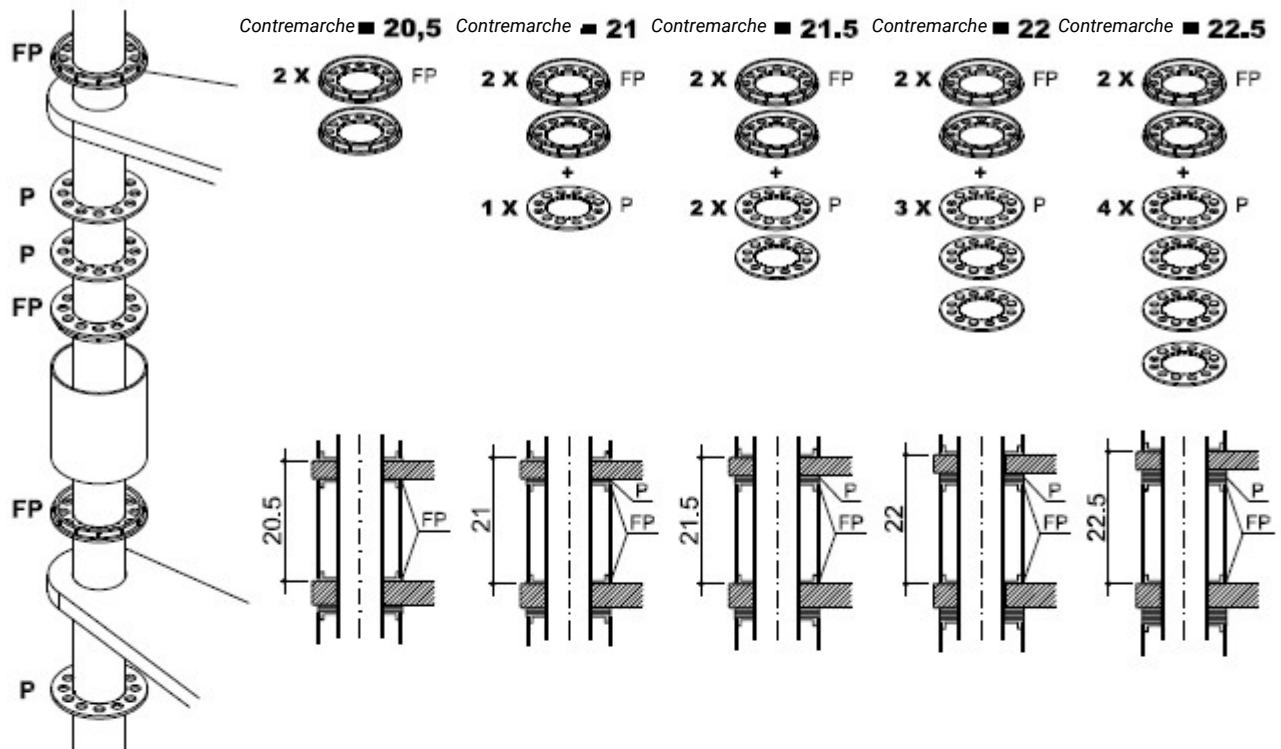

ASSEMBLAGE DE L'ESCALIER

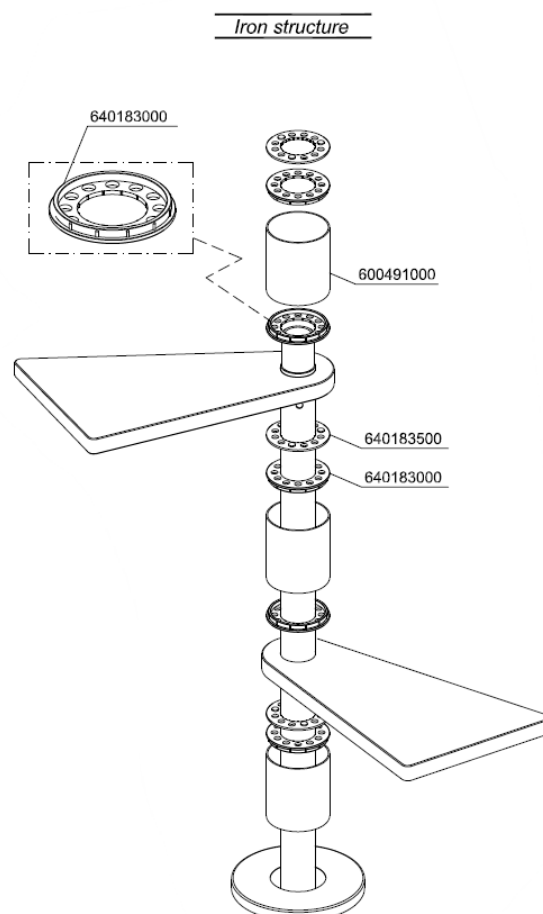
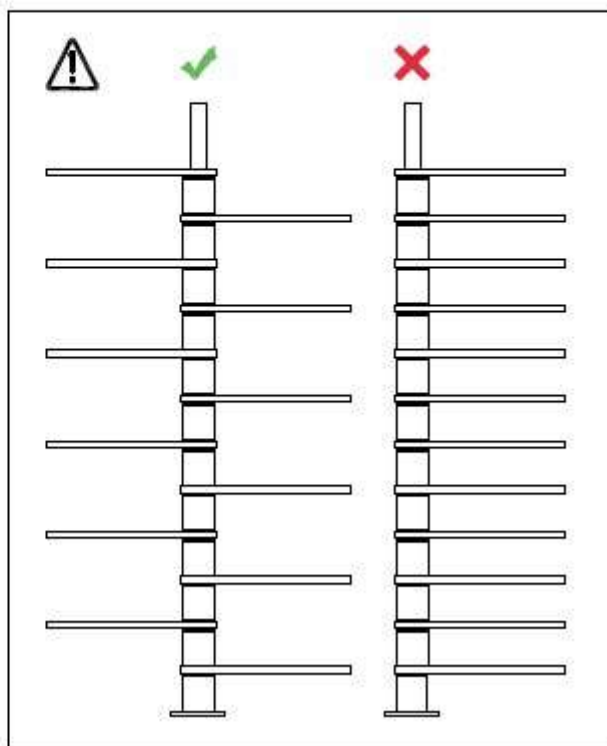
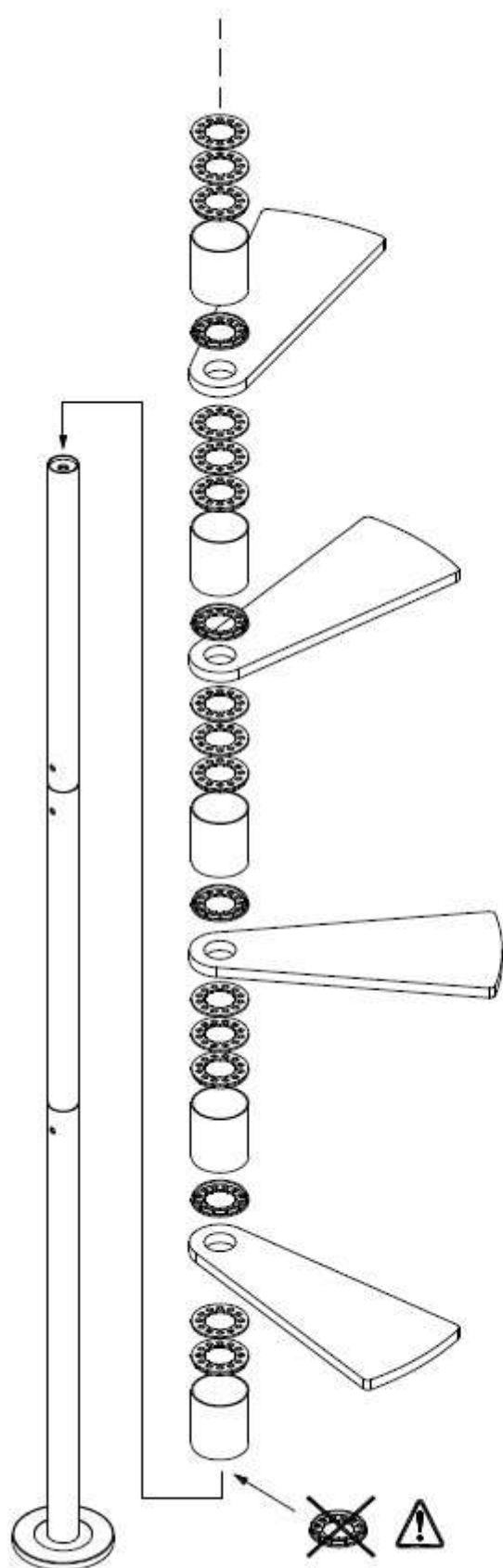

ASSEMBLAGE PALIER DE SORTIE

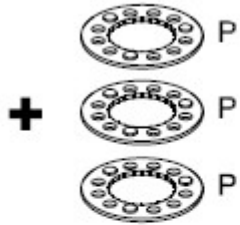
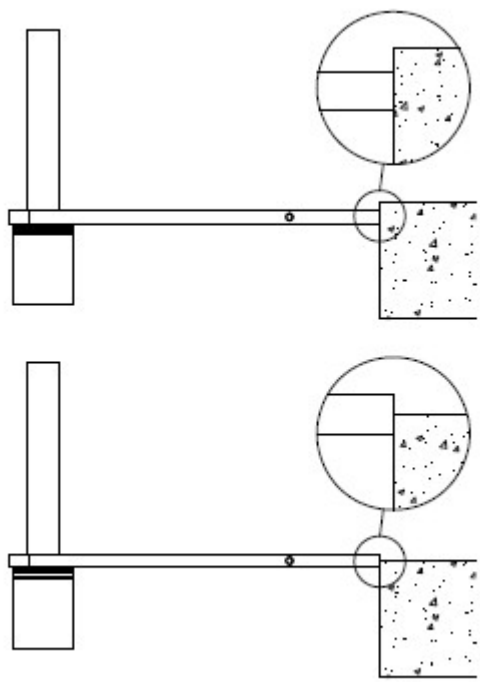
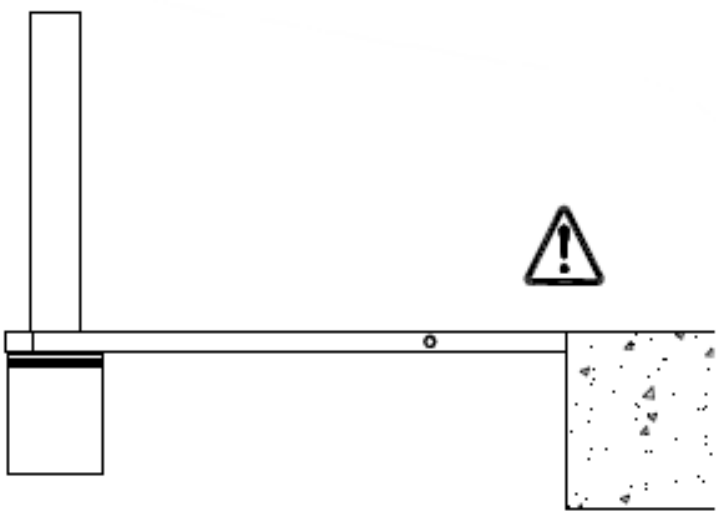

1 P = 0,5 cm

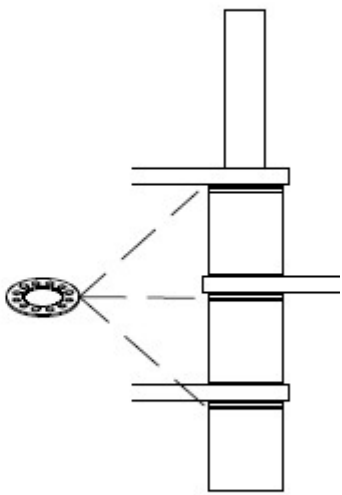
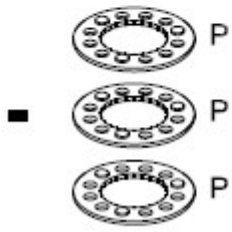

POSITIONNEMENT PALIER DE SORTIE

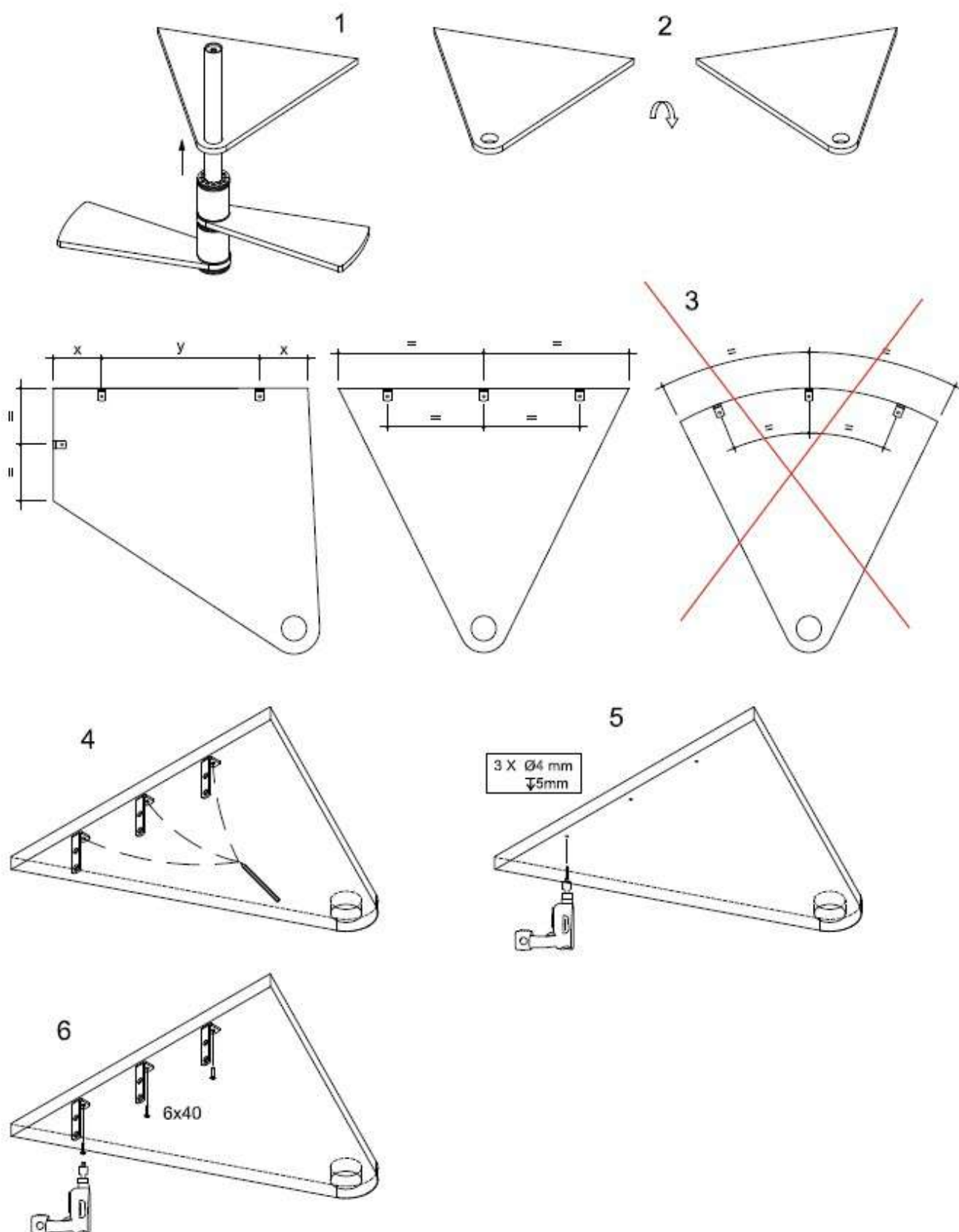

FIXATION ESCALIER A LA DALLE

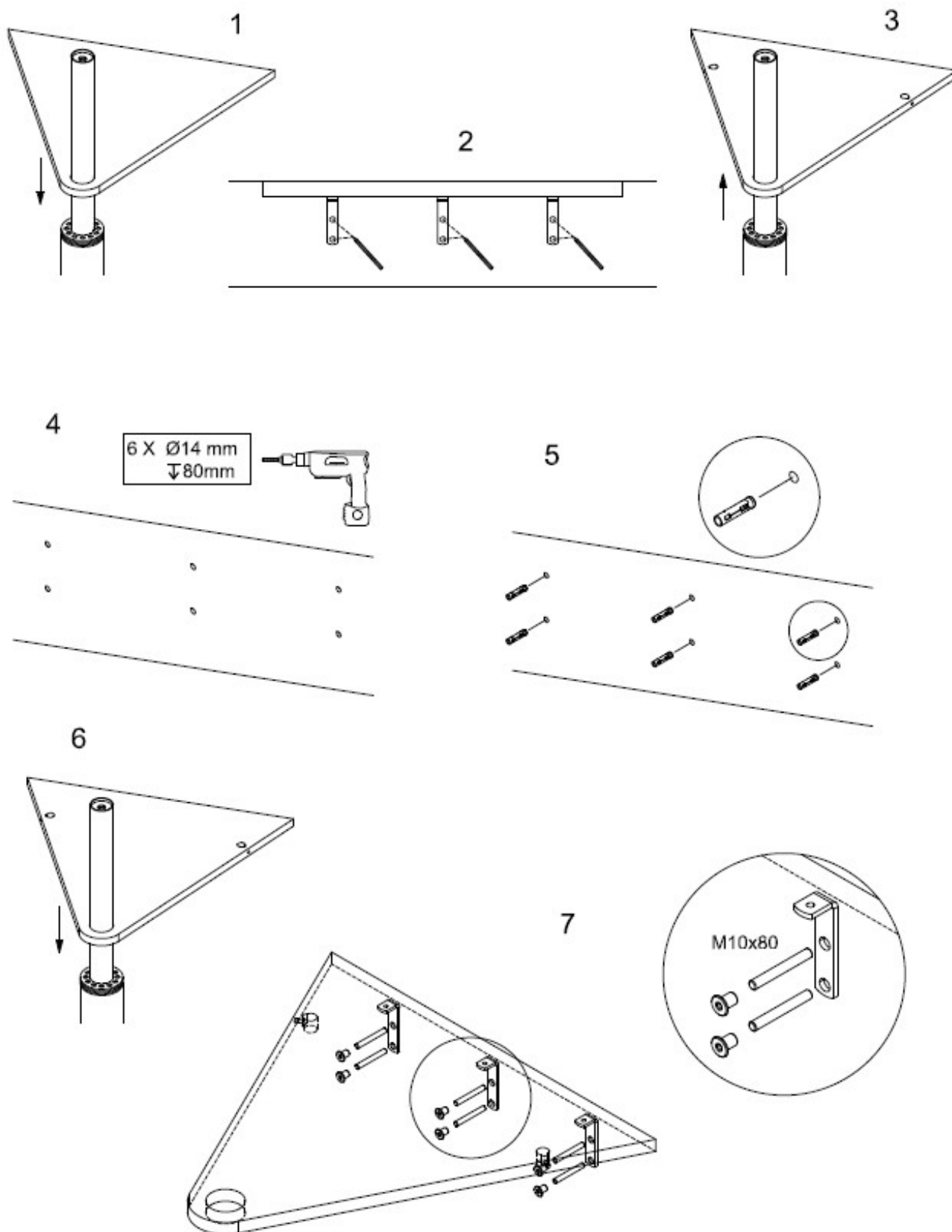

SERRAGE DE L'ESCALIER

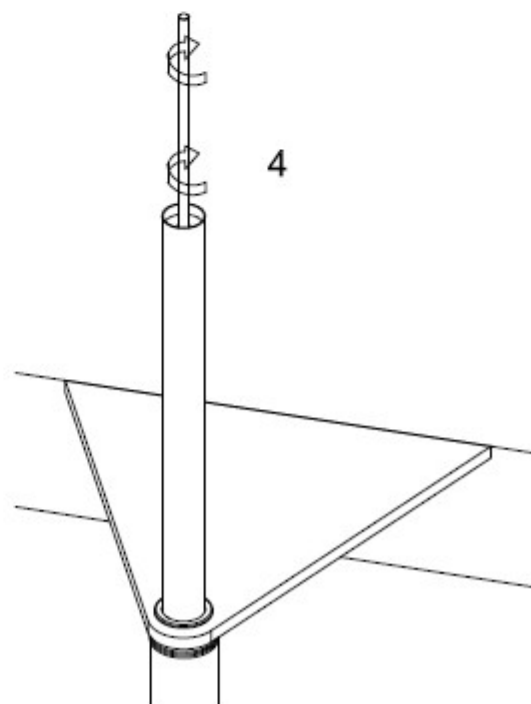
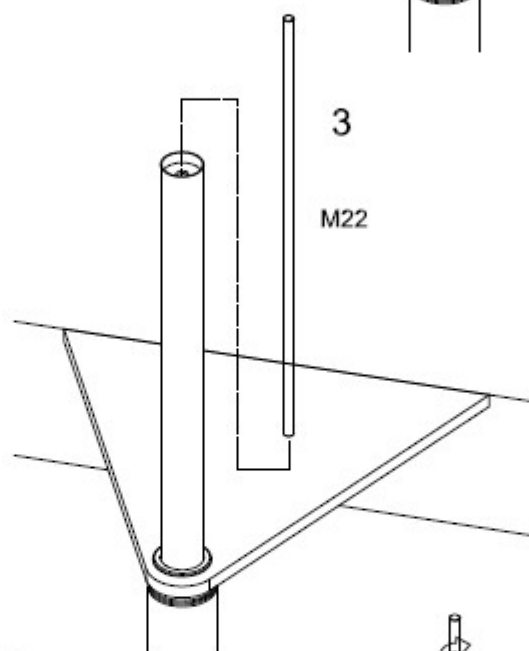
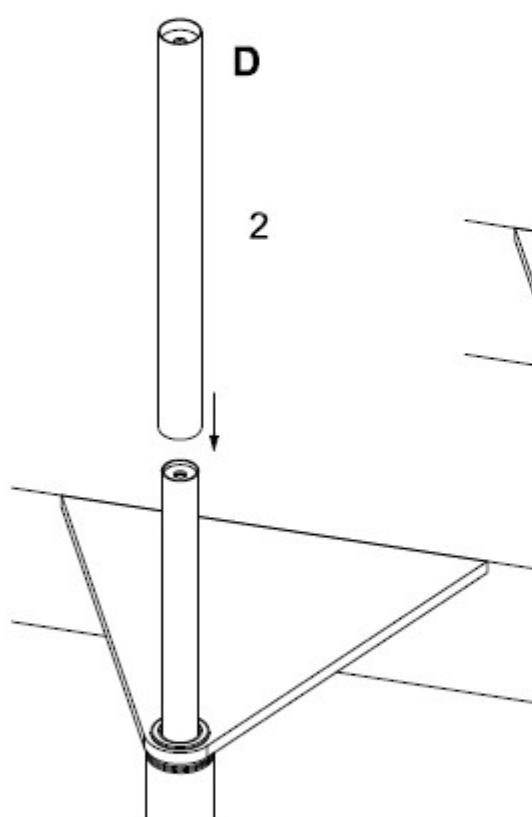
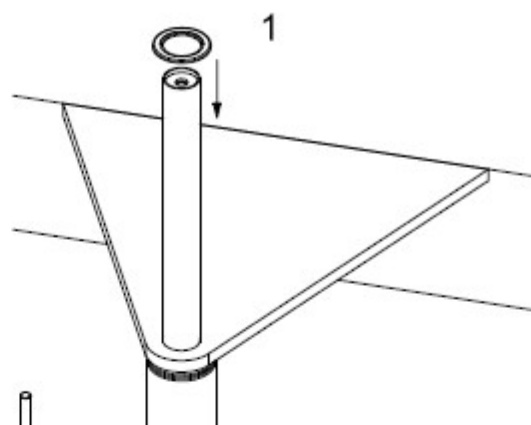
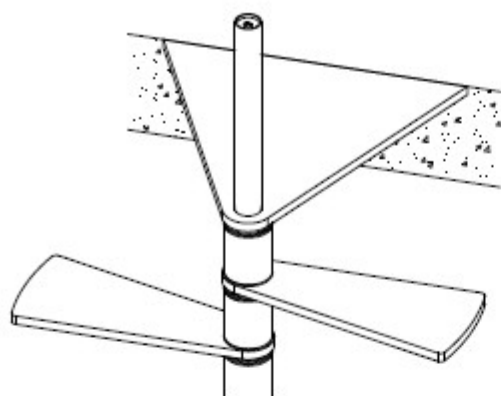

5



*Veuillez pas serrer
complètement.*

Iron structure

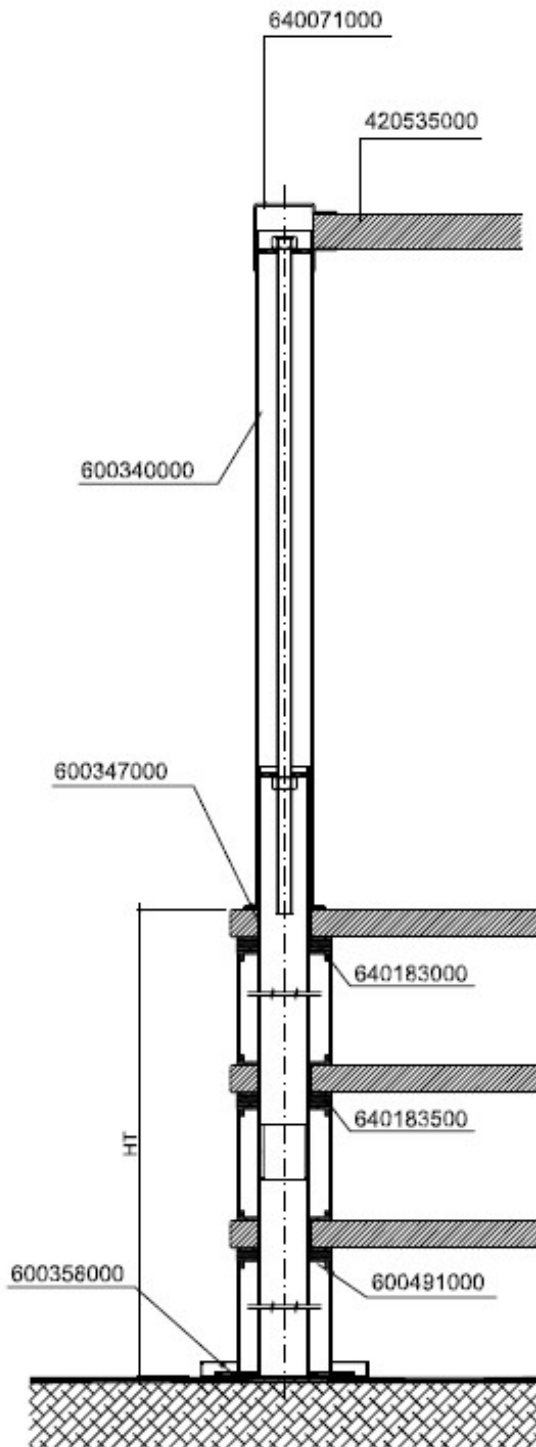

15

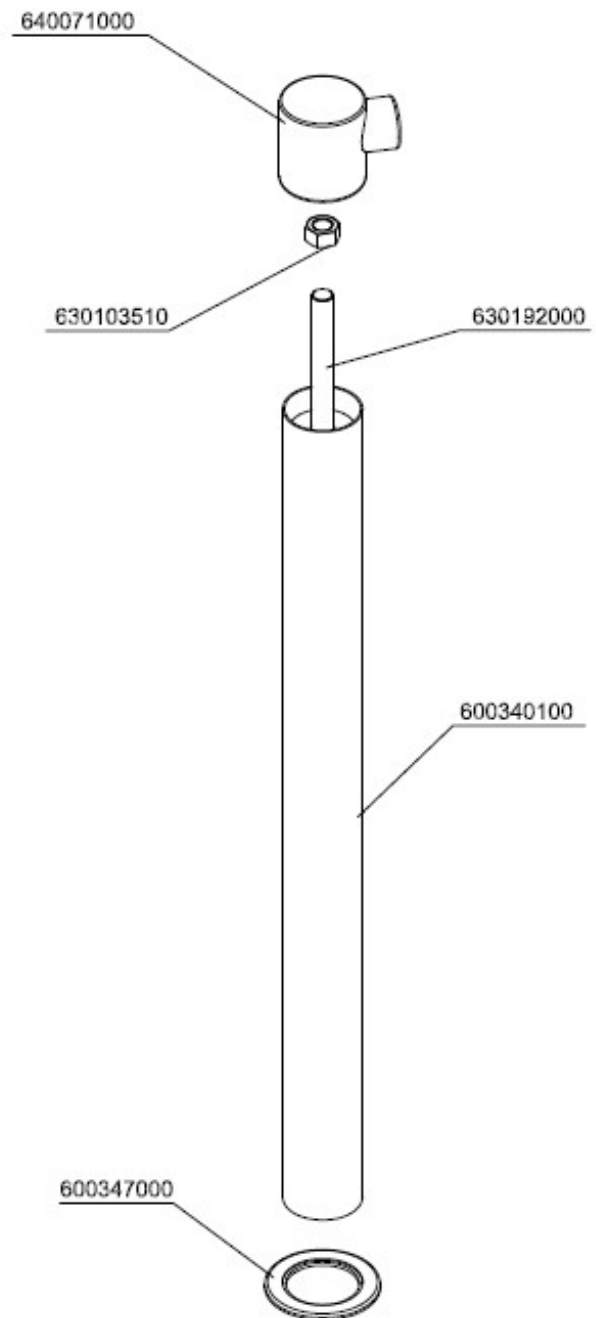

ASSEMBLAGE DES CONNEXIONS COLONNE-RAMPE

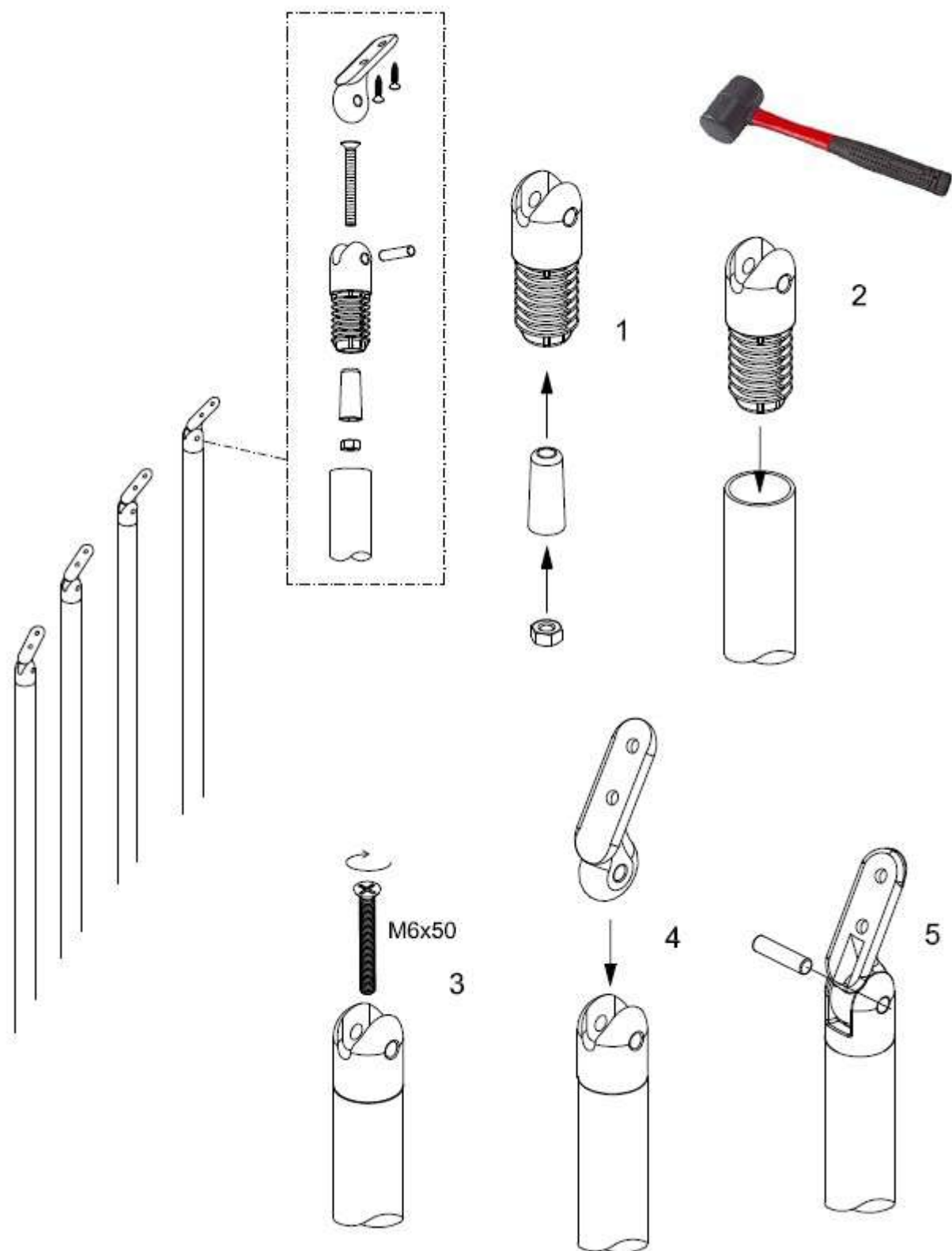

TEKLA - smart design

PROSPECT Ø1050 – Contremarche 210

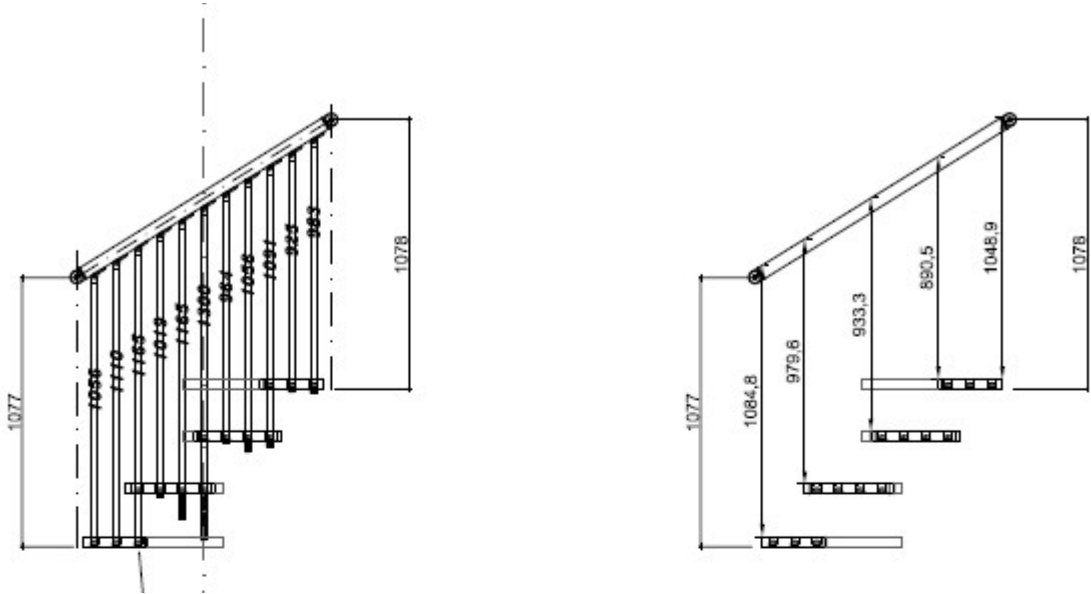

TEKLA - smart design

PROSPECT Ø1200 – Contremarche 210

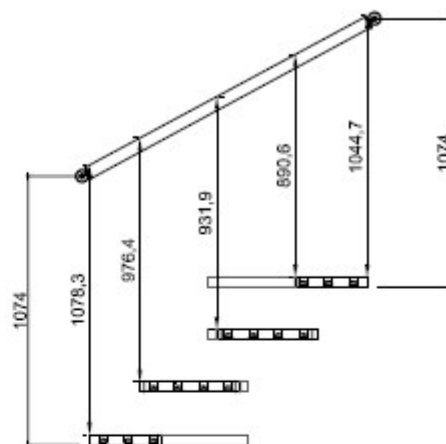
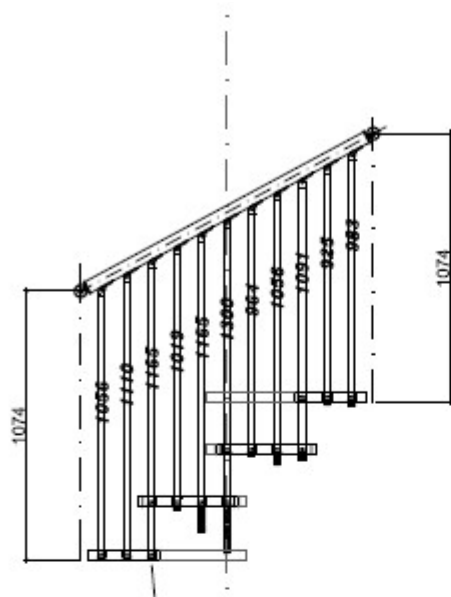

TEKLA - smart design

PROSPECT Ø1200 – Contremarche 240

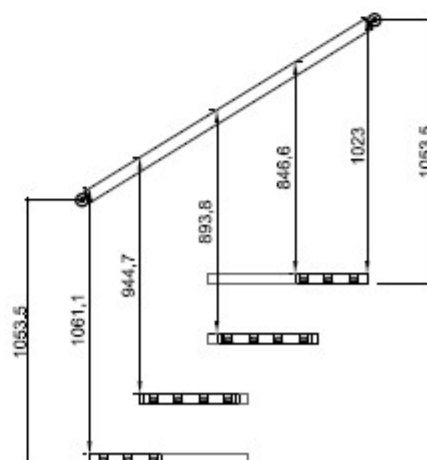
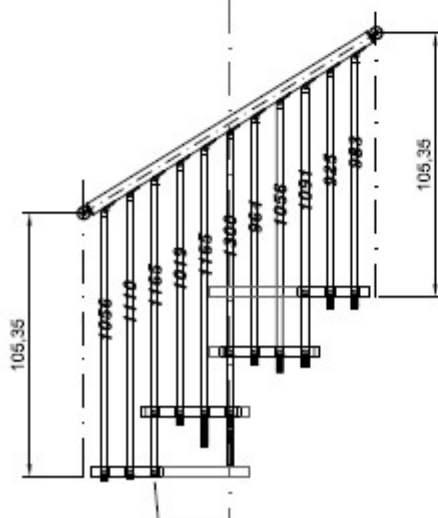

TEKLA - smart design

PROSPECT Ø1400 – Contremarche 210

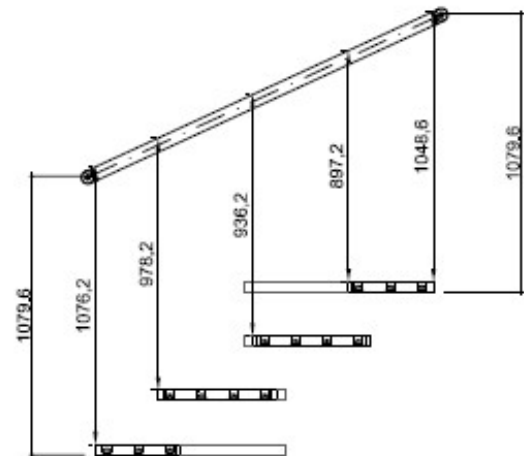
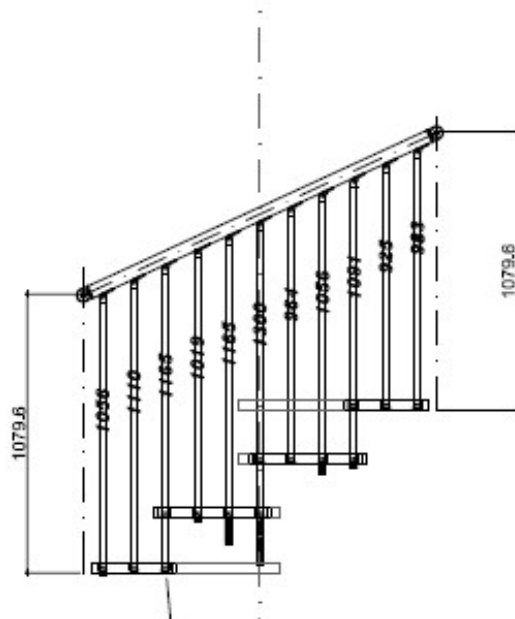

TEKLA - smart design

PROSPECT Ø1400 – Contremarche 240

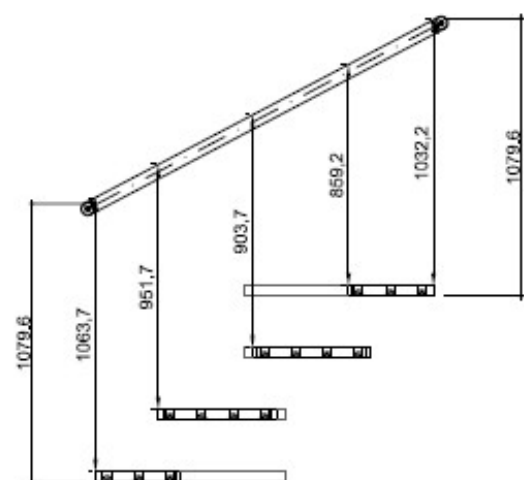
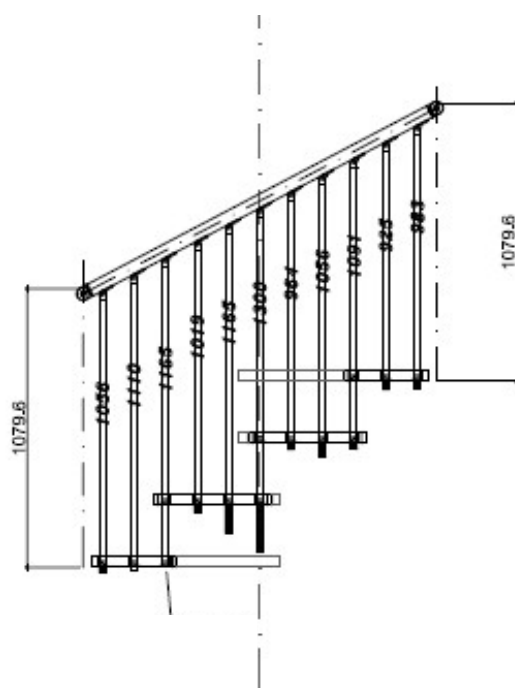

TEKLA - smart design

PROSPECT Ø1600 – Contremarche 210

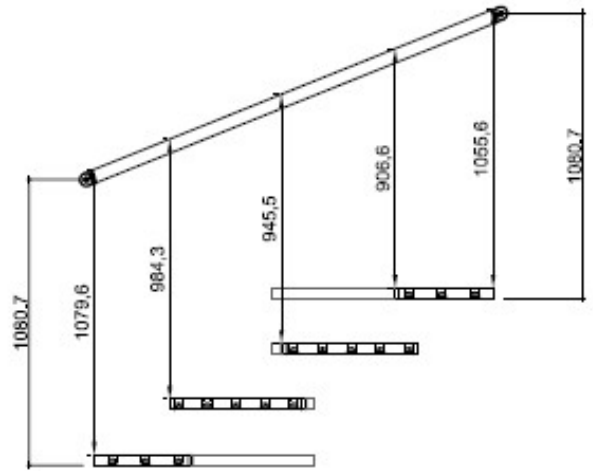
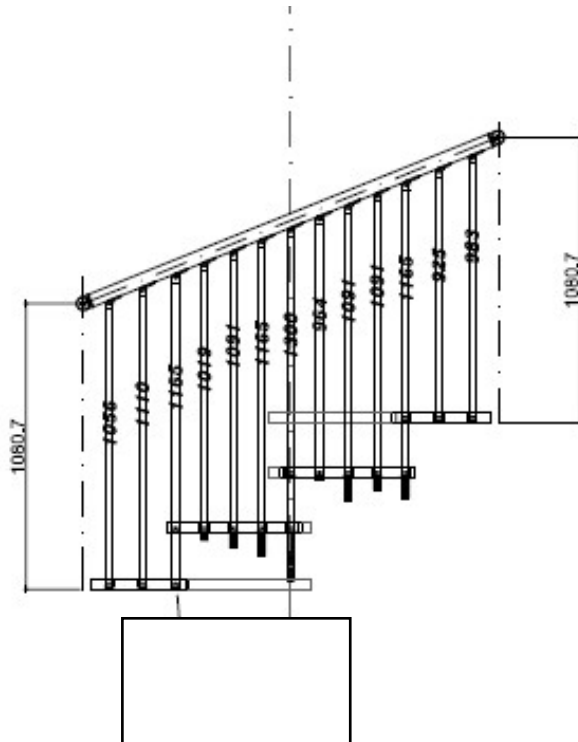

TEKLA - smart design

PROSPECT Ø1600 – Contremarche 240

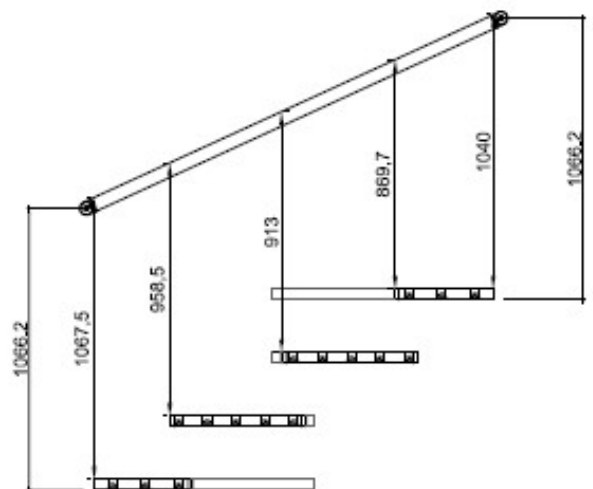
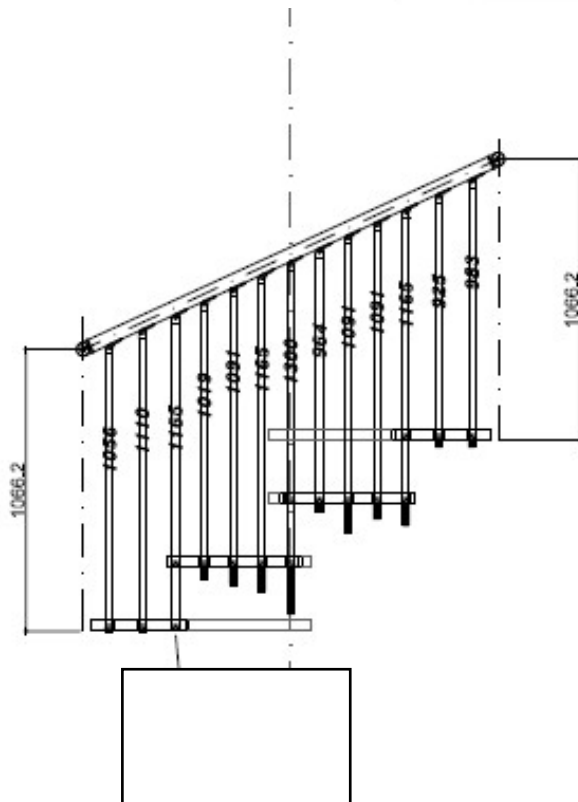

ASSEMBLAGE MAIN-COURANTE

35

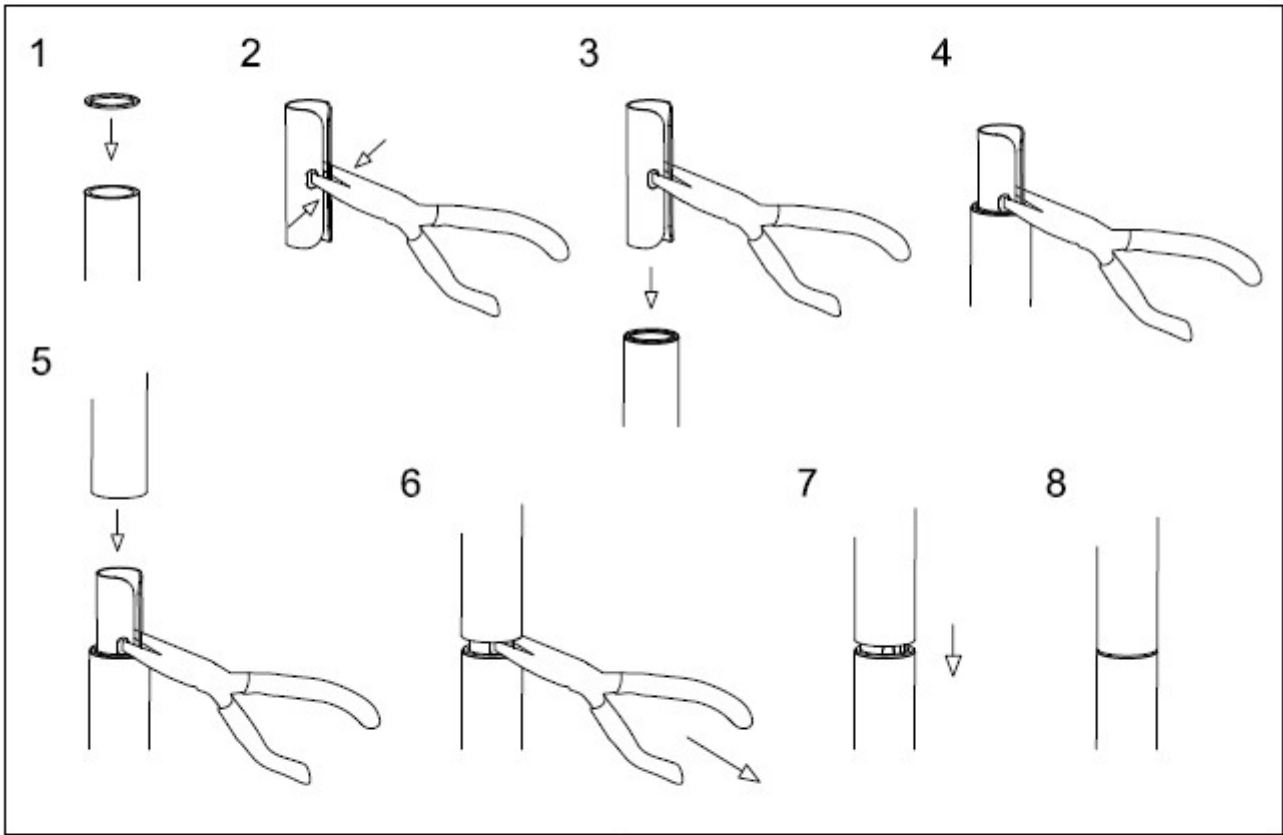

x 2

