

Zigzag dorato rubinetteria dorata inclusa

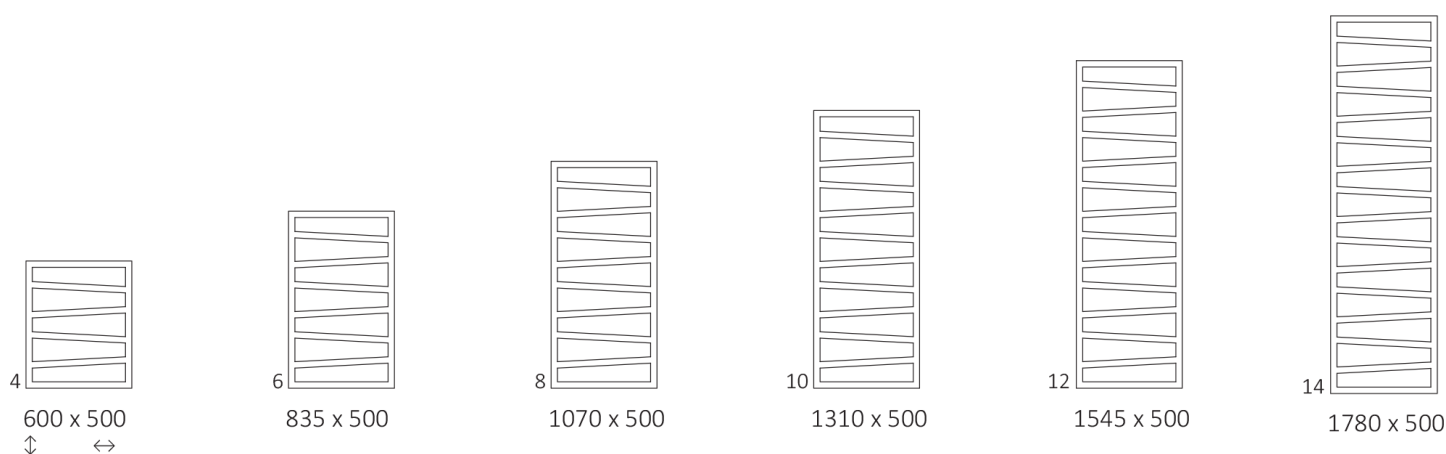

Zigzag dorato rubinetteria dorata inclusa

Dimensioni disponibili:



Predisposizione:



Dati tecnici:

Pressione di lavoro: 1000 kPa

Temperatura massima di lavoro: 95°C

A ↕ [mm]	B ↔ [mm]	C2 [mm]	75/65/20°C [W]	55/45/20°C [W]	Potenza [W]	D [mm]	E [mm]	F [mm]	Capacità [dm³]	Peso [kg]
600	500	470	249	134	300	470	420	90	2.77	7.32
835	500	470	320	172	300	470	655	90	3.74	9.89
1070	500	470	406	218	400	470	890	90	4.72	12.46
1310	500	470	490	263	600	470	1130	90	5.70	15.06
1545	500	470	581	311	600	470	1365	90	6.67	17.63
1780	500	470	627	335	600	470	1600	90	7.65	20.21

Disegno tecnico

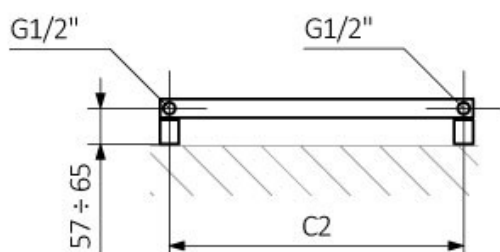
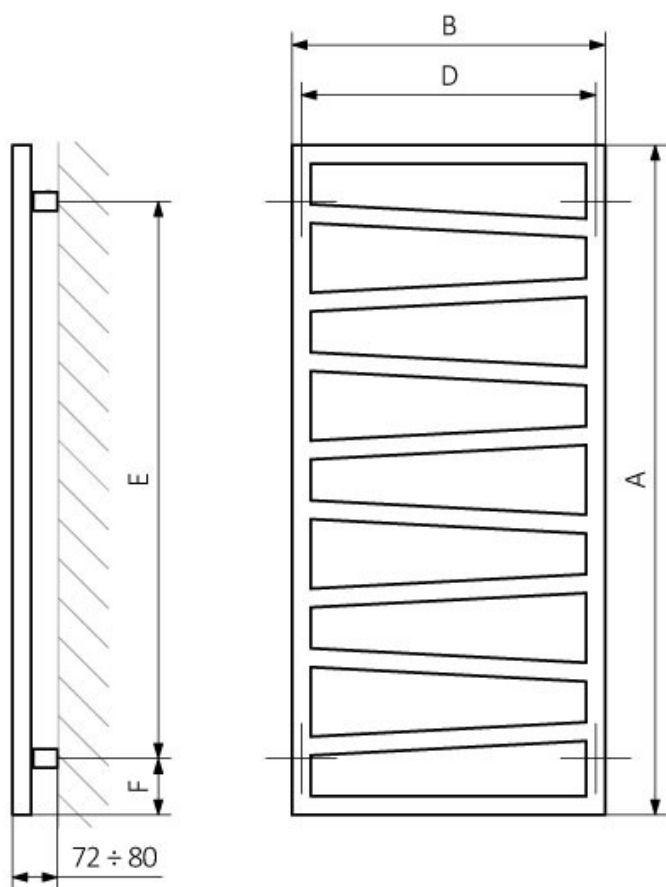
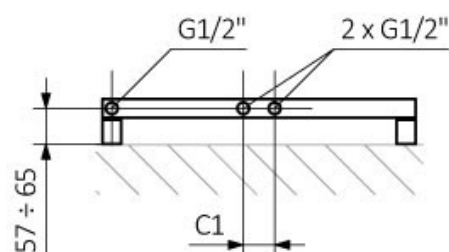
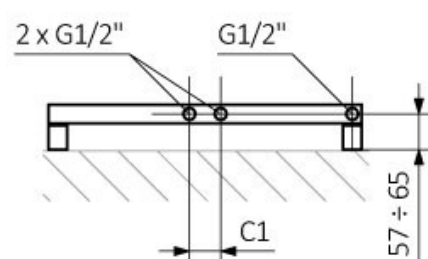
SX

Z1

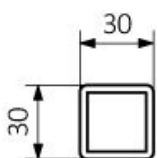
Z8

A - altezza B - larghezza C1-C5 - distanza tra i collegamenti D - distanza orizzontale tra i fissaggi E - distanza verticale tra i dispositivi F - distanza tra l'asse inferiore dei fissaggi e il bordo inferiore del collettore

Collettore:

Rubinetteria dorata inclusa

- Valvola termostatica angolare
- Testa termostatica 30x1,5, testa a destra
- Set di mascheratura
- 2 adattatori multistrato o per 16x2
- 2 adattatori in rame Ø15

Disegno tecnico

- Valvola termostatica angolare

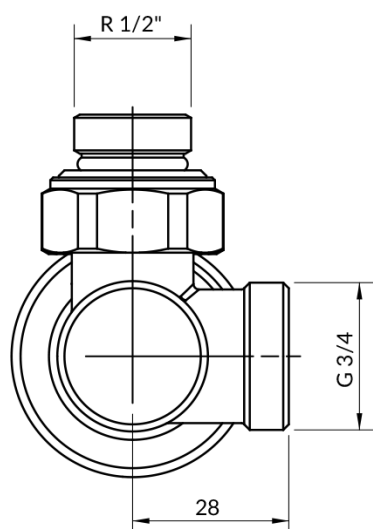

- Set di mascheratura

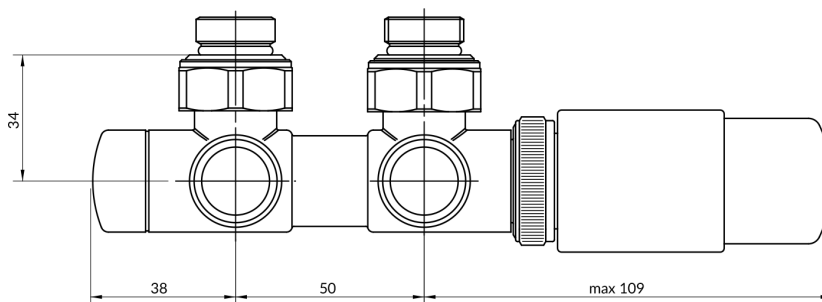
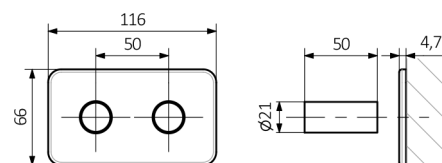

Testa termostatica