

Outcorner

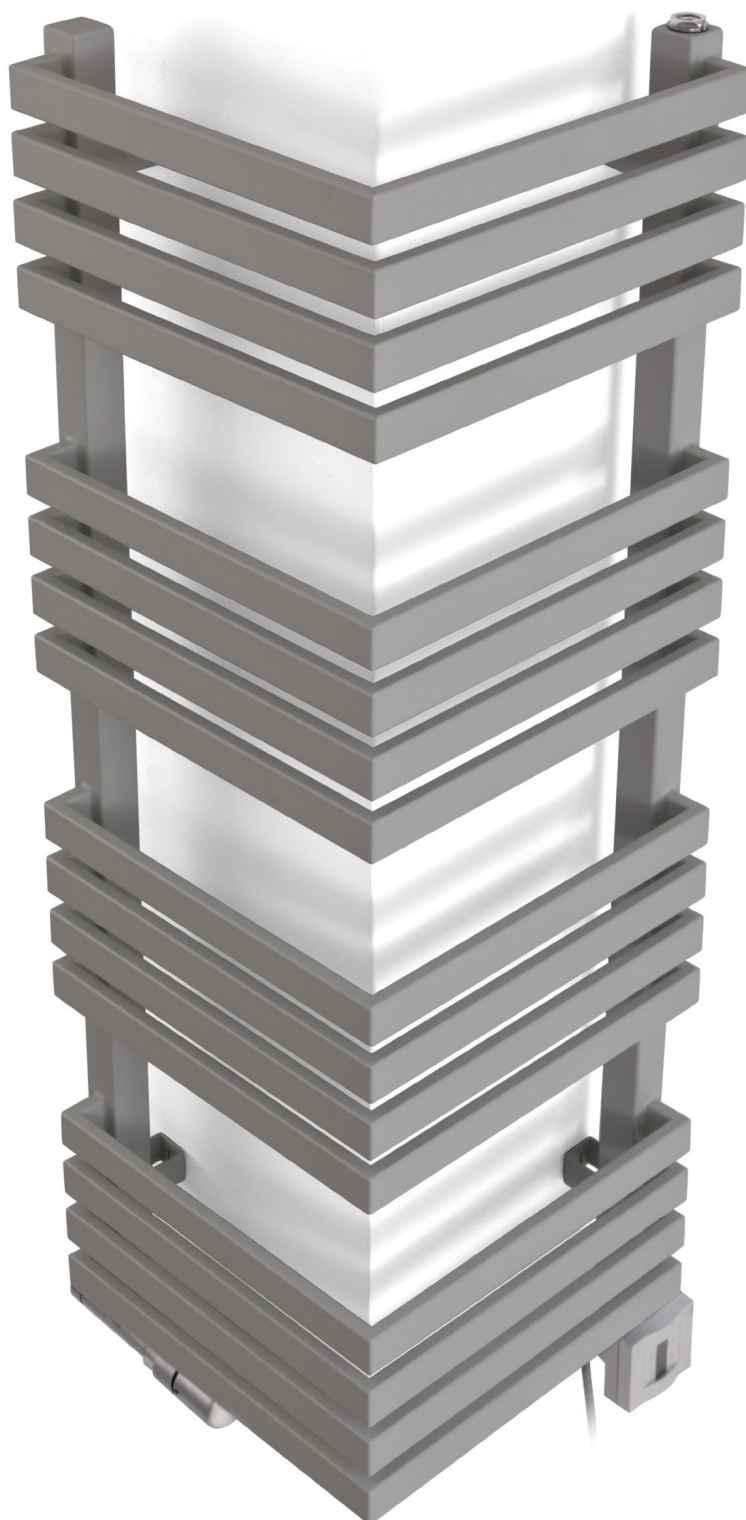

Colore : Winter Sky

Outcorner

Predisposizioni

Ad acqua calda



Elettrico



Misto



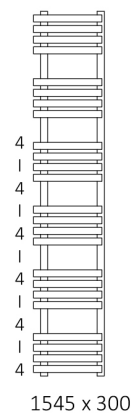
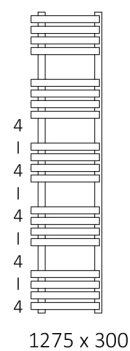
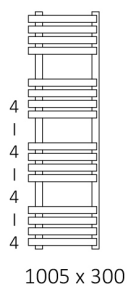
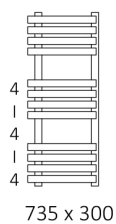
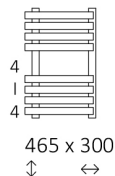

Dimensioni disponibili



Outcorner

Informazioni tecniche :

Pressione del lavoro : 1.0 MPa Temperatura massima di lavoro : 95°C

A ↕	B ↔	C2 [mm]	75 65 20°C [W]	55 45 20°C [W]	 [W]	D [mm]	E [mm]	F [mm]	 [dm³]	 [kg]
465	300	195	294	160	300	195	315	76	1,56	5,32
735	300	195	421	228	400	195	585	76	2,39	8,08
1005	300	195	547	294	600	195	855	76	3,22	10,84
1275	300	195	673	361	800	195	1125	76	4,05	13,60
1545	300	195	799	428	800	195	1395	76	4,89	16,36

Outcorner

SX

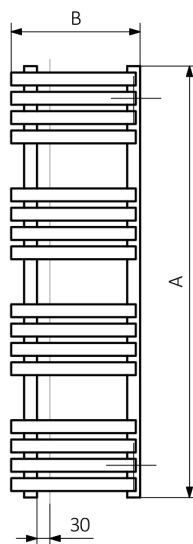
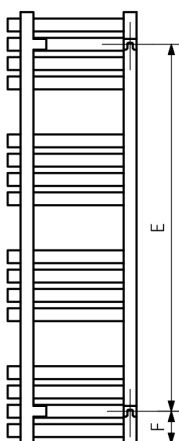
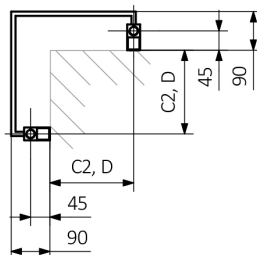

A - Altezza / B - Larghezza / C1-C5 - Distanza tra i raccordi / D - Interasse tra i tubi verticali / E - Distanza tra i punti di fissaggio / F - Distanza dell'asse del punto di fissaggio inferiore al bordo inferiore dello scaldasalviette

Collettore :

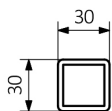

Profilo :

